

Caditoia piana in Ghisa Sferoidale Classe C250

Serie Lamda



IGQ P027
UNI EN 124



Soggetta a Direzione e Coordinamento
ex 2497 cc da Mufite S.p.A.

TOMBI S.U.R.L.

Via dell'Industria, 5 - 62017 Porto Recanati (MC) - Italy
Telefono +39 071 7590699 - Fax +39 071 2504804 - info@tombi.it - www.tombi.it
Codice Fiscale e Partita IVA 01643280439 - Capitale Sociale € 100.000,00 i.v. - C.I.A.A. MC 01643280439 - REA 169440

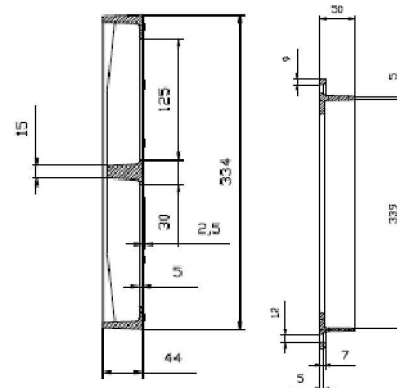
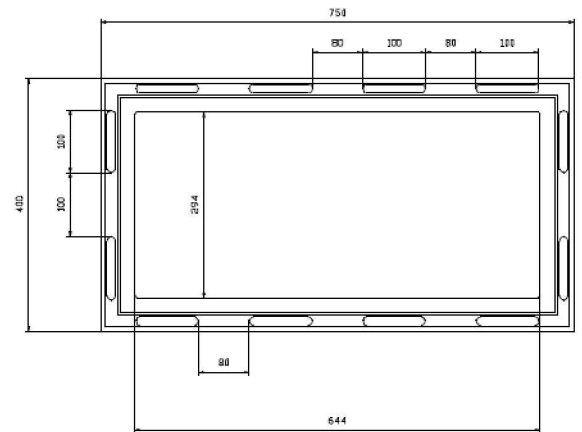
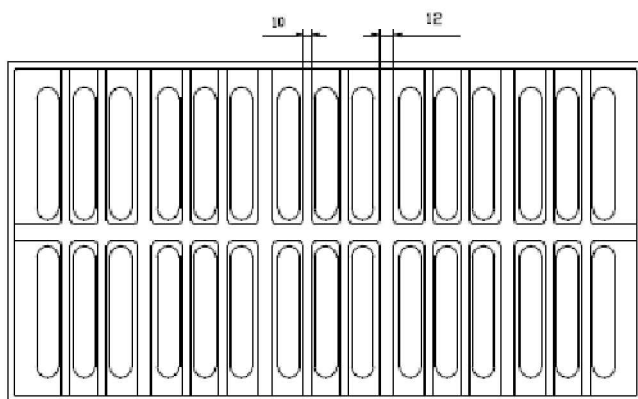
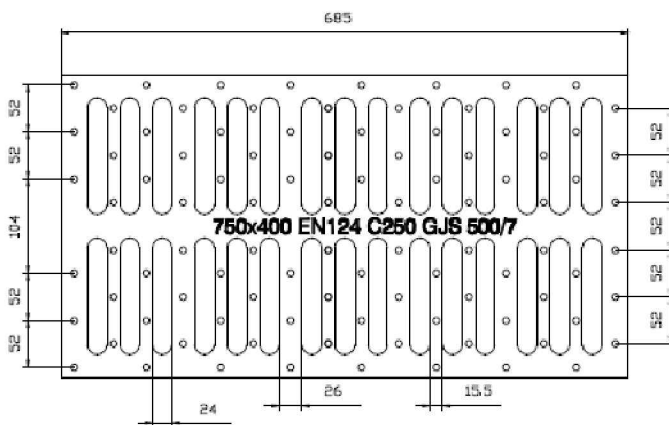

Specification

1. Unspecified cast corner is R3-R6.
2. Unspecified draft angle is 1°-2.5°.
3. Unspecified dimension tolerance as per ISO8642-01 Grade 12.
4. Casting load and deformation should meet the requirements of the standard EN124-1964.